

VN LOAD CELL

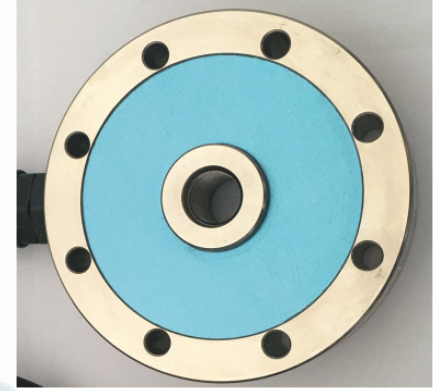

This type load cell is ideal for use in truck scales, weight, force measurement and automatic weight control units.

Features

- Low profile
- High accuracy
- Tension and compression
- 25, 50, 100, 250, 500 N
1, 2, 2.5, 5, 10, 20, 30, 50, 100, 200, 300, 500, 1000, 2000 kN
- Thermally compensated
- Resistance to extraneous forces
- Hermetically sealed

Installation Dimensions

VN-25 N-2 kN E:4hole VN-100kN-200kN E: 12hole
VN-2.5 kN-50 kN E:8hole VN-300kN-2000kN E:16hole

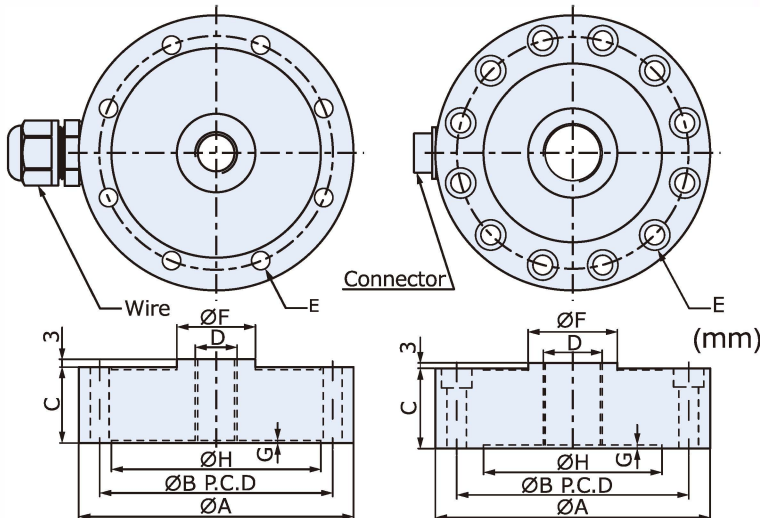

TYPE	A	B	C	D	E	F	G	H
VN-25 N (2.549 kgf)								
VN-50 N (5.099 kgf)								
VN-100 N (10.20 kgf)								
VN-250 N (25.49 kgf)	75	60	20	M10×1.5	(4)Ø7.0 hole	20	1	50
VN-500 N (50.99 kgf)								
VN-1 kN (102.0 kgf)								
VN-2 kN (203.9 kgf)								
VN-2.5 kN (254.9 kgf)								
VN-5 kN (509.9 kgf)								
VN-10 kN (1.020 tf)	105	89	29	M16×2.0	(8)Ø7.0 hole	30	1	80
VN-20 kN (2.039 tf)								
VN-30 kN (3.059 tf)								
VN-50 kN (5.099 tf)	105	89	32	M16×2.0	(8)Ø7.0 hole	30	1	80
VN-100 kN (10.20 tf)								
VN-200 kN (20.39 tf)	154	130	45	M33×2.0	(12)Ø10.5 hole Ø17X11 deep	50	2	100
VN-300 kN (30.59 tf)								
VN-500 kN (50.99 tf)	197	165	50	M42×2.0	(16)Ø13 hole Ø19X13 deep	90	2	142
VN-1000 kN (102.0 tf)								
VN-2000 kN (203.9 tf)	278	229	96	M72×2.0	(16)Ø18 hole Ø26X18 deep	118	2	196

Specification

Rated Output	2.0mV/V(25 N~2 kN:1.5mV/V)
Total Error	±0.05%R.O.
Repeatability	±0.03%R.O.
Creep	0.05%/20min
Input Resistance	430 or 405 ± 25Ω
Output Resistance	350 ± 5Ω
Max. Excitation Voltage	20V
Recommended Excitation Voltage	10V
Compensated Temp.Range	-10°C~50°C
Safe Temp. Range	-20°C~70°C
Temp. Effect on Zero Balance	0.05%R.O./10°C
Temp. Effect on Rated Output	0.03%Load/10°C
Zero Balance	±3%R.O.
Safe Over Load Rating	150%
Cable Length	3m
Cable Connection	Input: Red(+)Exci : Black(-)Exci Output: Green(+)Sign White(-)Sign